

ACOUSTICAL ANALYSIS REPORT

CLIENT: *****	CLIENT PHONE(S): *****
PHYSICAL ADDRESS: ***** Venice FL 33616 (Clubhouse building)	FIELD CONTACT: ***** TITLE: SPECIAL INSTRUCTIONS:
PRE-INSTALLATION CONDITIONS & DATA	POST-INSTALLATION CONDITIONS & DATA
TECHNICIAN(S): L. Johnson	TECHNICIAN(S): S. Kinney
START DATE/TIME: 2/5/04 11:30	START DATE/TIME: 1/21/05 15:50
END DATE/TIME:	END DATE/TIME: 1/21/05 16:10
TEMPERATURE: 80 deg F HUMIDITY: 54 %	TEMPERATURE: 68 deg F HUMIDITY: 65 %
WIND SPEED: var 5-10 mph DIRECTION: ESE	WIND SPEED: 0 – 2 DIRECTION: var
EQUIPMENT USED (Maker/Model): Sencore SP 295 Photos of facility were also taken	EQUIPMENT USED (Maker/Model): Sencore SP 295 Digital photos of facility were also taken
INCIDENTAL NOISE SOURCES:	INCIDENTAL NOISE SOURCES: Construction site 100 yds N, drills & hammers etc.

LOCATION	PRE-INSTALLATION				POST-INSTALLATION				DIFFERENCE	
	NC	LMTG BAND	LB DB	SPL DB	NC	LMTG BAND	LB DB	SPL DB	NC	SPL
	1		500		73				52.2	
2		500		74				51.8		-22.2
3		500		73				52.3		-20.7
4		500		69				52.1		-16.9
5		500		85				53.2		-31.8

LOCATION: See attached map specifying location of test readings.
NC: Noise Criteria, preferred measurement relative to human hearing & regulatory requirements.
SPL: Sound Pressure Level is raw sound energy, not as relative to human hearing or noise criteria.
SPL: SPL readings are in the A-weighted scale normally cited by regulatory agencies.

Average noise reduction at test points, 22.48 dB

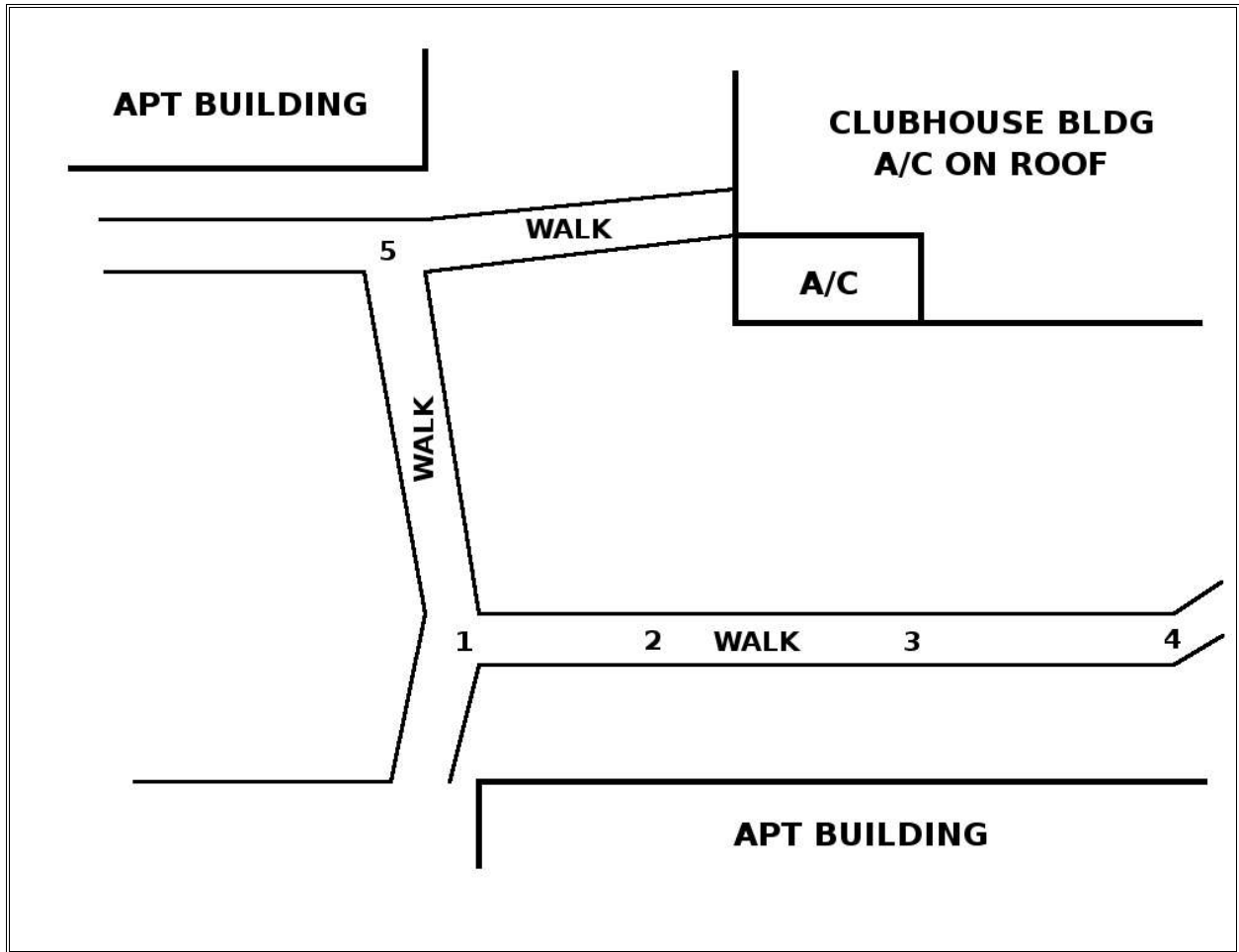

Schematic map showing test point locations relative to facility locations.
View facing West



BEFORE INSTALLATION



AFTER INSTALLATION